

# **Reconstruct Track Facility**

**Littleton Special Town Meeting**

**Article 3**

**Nov 14, 2011**

**Paul Avella, Chair, School Committee**  
**William Seymour, Gale Associates**

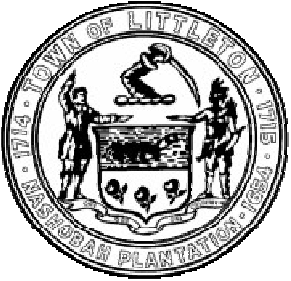

# Current Track



- Unsafe/unusable for interscholastic competition
- Recreational use is compromised
- Beyond economical repair

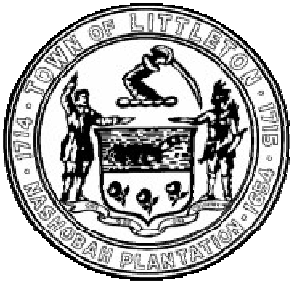

# Track History



1979

...

2008

2009

2010

2011

Track built with  
community funding

Track declared unsafe  
for HS track events

Feasibility Study  
Approved @ TM  
May 9, 2009 – 3 options

Design Development  
Approved @ TM  
May 3, 2010 – RSS site

Project Scoped for  
Benefit/Cost/Impact

*Tonight, TM  
Nov 14, 2011*

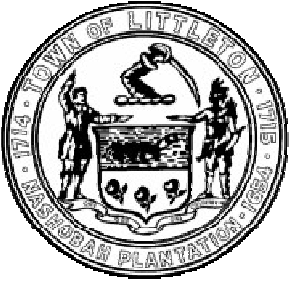

# Community Issues



- Benefit
  - Supports largest community of HS athletics
  - Continued commitment to health and exercise as integral element of education
  - Community resource for events and exercise
- Cost
  - Final configuration evaluated with cost impact while not sacrificing usability
  - Worked with community members
- Maintenance
  - Included in budget plan for ALL school sports facilities
  - Littleton Track Organization support

**William 'Bill' Seymour**

**Gale Associates**

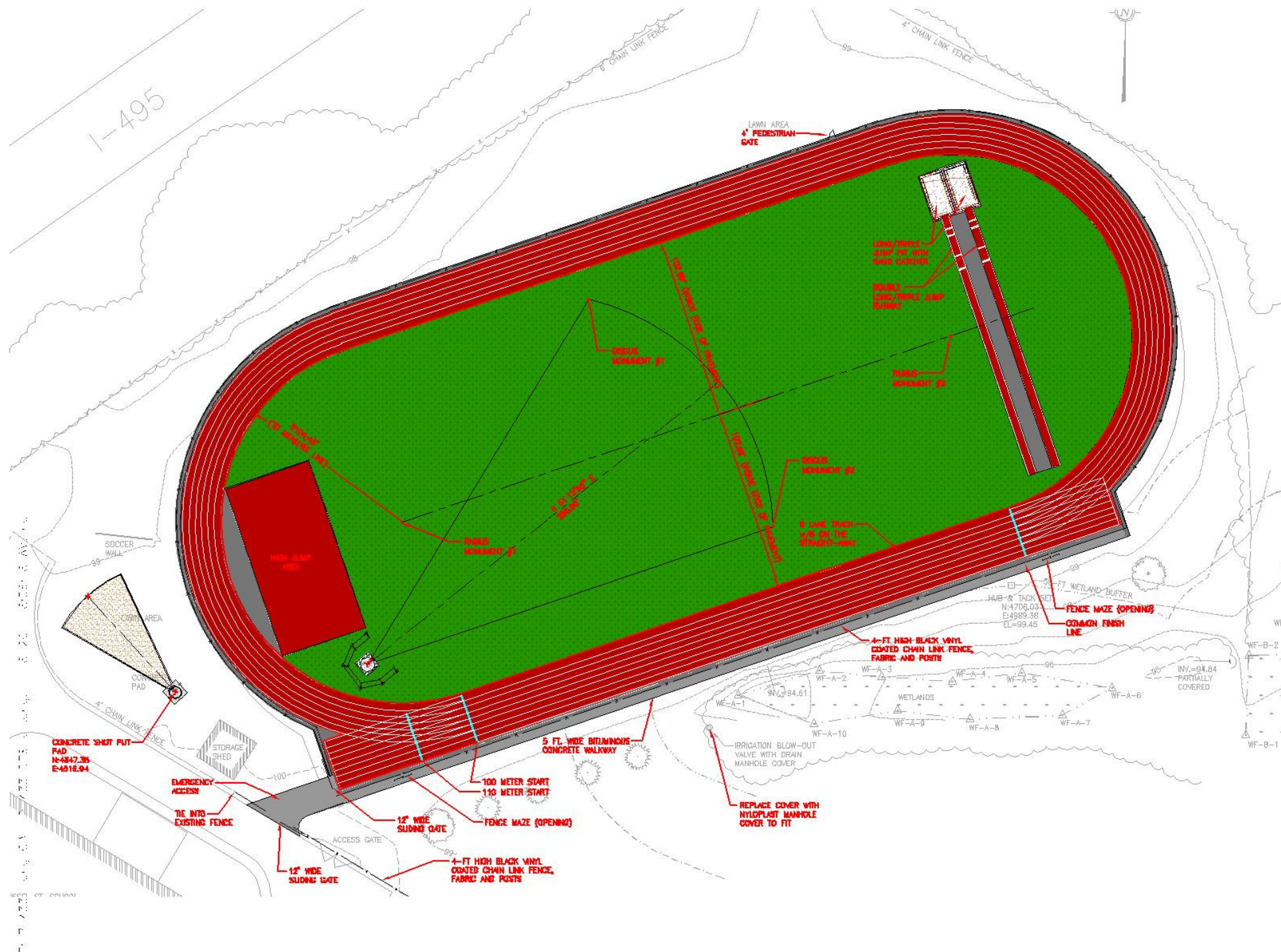



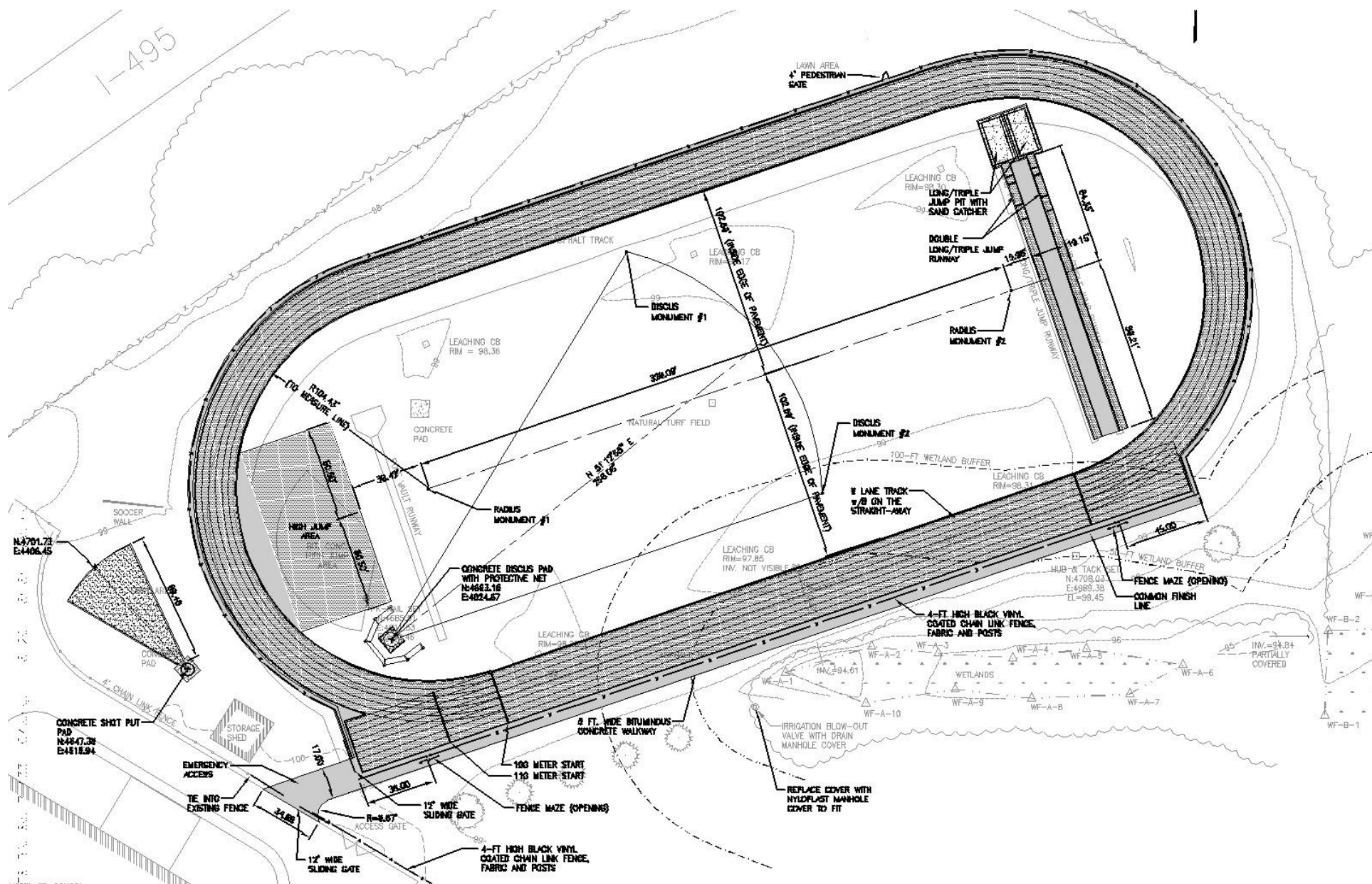

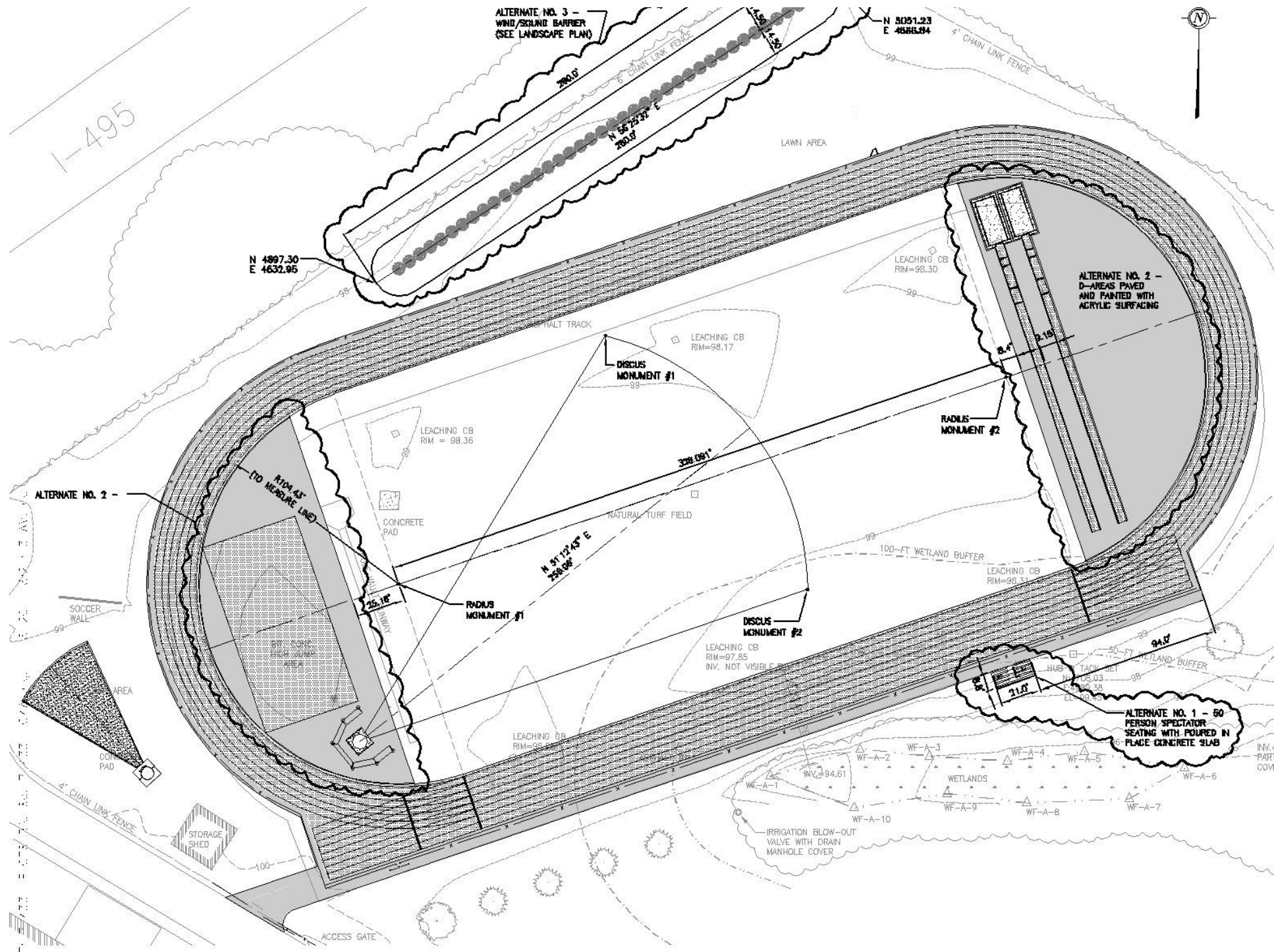





## BASE BID ESTIMATE

ITEM	DESCRIPTION	UNIT	QUANTITY	UNIT COST	COST	TOTAL COST
<b>1</b>	<b>General Overhead</b>					
1a	Bonds and Insurance	LS	1	\$ 20,000	\$ 20,000.00	\$ 35,000.00
1b	Mobilization	LS	1	\$ 10,000	\$ 10,000.00	
1c	Layout and materials testing	LS	1	\$ 5,000	\$ 5,000.00	
<b>2</b>	<b>Site Preparation</b>					\$ 28,504.00
2a	Stabilized Construction Entrance	CY	37	\$ 52.00	\$ 1,924.00	
2b	Erosion and Sedimentation Control Devices	LF	460	\$ 8.00	\$ 3,680.00	
2c	Strip and Screen and stockpile topsoil (assume 8")	CY	575	\$ 12.00	\$ 6,900.00	
2d	Pulverize in place existing track	SY	4000	\$ 4.00	\$ 16,000.00	
<b>3</b>	<b>Demolition</b>					\$ 17,915.00
3a	Misc. Demolition	LS	1	\$ 5,000.00	\$ 5,000.00	
3b	Drainage Structures	EA	6	\$ 1,200.00	\$ 7,200.00	
3c	Drainage Pipe	LF	55	\$ 13.00	\$ 715.00	
3d	Remove Field Events	LS	1	\$ 5,000.00	\$ 5,000.00	
<b>4</b>	<b>Athletic Surfacing (Natural Turf Grass Repairs)</b>					\$ 37,800.00
4a	Grade disturbed athletic areas	SY	2200	\$ 2.00	\$ 4,400.00	
4b	Install Topsoil	CY	740	\$ 35.00	\$ 25,900.00	
4c	Seed Athletic Field Mix and fine grade	SF	20,000	\$ 0.30	\$ 6,000.00	
4d	Turf establishment requirements	LS	1	\$ 1,500.00	\$ 1,500.00	
<b>5</b>	<b>Subsurface Drainage (Natural Turf Field)</b>					\$ 29,190.00
5a	Leaching pits	EA	6	\$ 1,825.00	\$ 10,950.00	
5b	12" Solid HDPE	LF	60	\$ 32.00	\$ 1,920.00	
5c	10" Perf. HDPE	LF	510	\$ 32.00	\$ 16,320.00	
<b>6</b>	<b>Fencing</b>					\$ 67,800.00
6a	4' chain link fence	LF	1530	\$ 40.00	\$ 61,200.00	
6b	4' wide pedestrian gate	EA	1	\$ 1,000.00	\$ 1,000.00	
6c	12' wide sliding maintenance gate	EA	2	\$ 2,800.00	\$ 5,600.00	
<b>7</b>	<b>Utilities</b>					\$ 9,500.00
7a	Water line relocation	LF	200	\$ 25.00	\$ 5,000.00	
7b	Infrastructure for future PA System (conduits and pull boxes)	LS	1	\$ 4,500.00	\$ 4,500.00	



<b>8</b>	<b>Track and Field Construction</b>					<b>\$ 316,747.60</b>
8a	Additional Aggregate Base for Track (4")	Ton	600	\$ 32.00	\$ 19,200.00	
8b	Prepare sub-base, shape, compact and fine grade	SY	4,835	\$ 2.00	\$ 9,670.00	
8c	Pavement (1.5" Binder course and 1.5" Wearing course)	SY	4,835	\$ 26.56	\$ 128,417.60	
8d	Track Surface (Polyresin latex)	SY	4,556	\$ 35.00	\$ 159,460.00	
<b>9</b>	<b>Walkways</b>					<b>\$ 30,804.00</b>
9a	Bituminous walkways areas with, 3" depth	SY	905	\$ 18.00	\$ 16,290.00	
9b	Aggregate base (6")	Ton	397	\$ 32.00	\$ 12,704.00	
9c	Prepare sub-base, shape, compact and fine grade	SY	905	\$ 2.00	\$ 1,810.00	
<b>10</b>	<b>Discus and Shot Put Venues</b>					<b>\$ 13,985.50</b>
10a	Discuss and Shot Put Pads (Concrete)	CY	2	\$ 500.00	\$ 1,000.00	
10b	Aggregate base beneath pads	Ton	5	\$ 30.00	\$ 157.50	
10c	Prepare sub-base, shape, compact and fine grade	SY	42	\$ 4.00	\$ 168.00	
10d	Shot Put Curb	LF	180	\$ 30.00	\$ 5,400.00	
10e	Shot put Sand/Clay Mix (6")	Ton	42	\$ 30.00	\$ 1,260.00	
10f	Shot Put Toe board	EA	1	\$ 500.00	\$ 500.00	
10g	Discus Cage and Net	EA	1	\$ 5,500.00	\$ 5,500.00	
<b>11</b>	<b>Long Jump Venues</b>					<b>\$ 30,000.00</b>
11a	Sand Pit Forms with Sand Catcher	EA	2	\$ 15,000.00	\$ 30,000.00	
<b>12</b>	<b>Pole Vault Runway and Paved Landing Area</b>					<b>\$ -</b>
12a	Gravel Base	Ton	0	\$ 32.00	\$ -	
12b	Pavement	SY	0	\$ 26.56	\$ -	
12c	Surfacing	SY	0	\$ 35.00	\$ -	
<b>13</b>	<b>Non-fixed track equipment to be purchased by the Town</b>					<b>\$ 23,217.00</b>
13a	Hurdles	EA	80	\$ 161.00	\$ 12,880.00	
13b	Hurdle Cart	EA	8	\$ 387.00	\$ 3,096.00	
13c	Starting Blocks	EA	8	\$ 280.00	\$ 2,240.00	
13d	High Jump Landing Pad	EA	1	\$ 4,352.00	\$ 4,352.00	
13e	High Jump Pad Cover	EA	1	\$ 649.00	\$ 649.00	
				<b>Sub-Total</b>		<b>\$ 640,463.10</b>
				<b>Contingency (10%)</b>		<b>\$64,046.31</b>
				<b>Budget total</b>		<b>\$ 704,509.41</b>

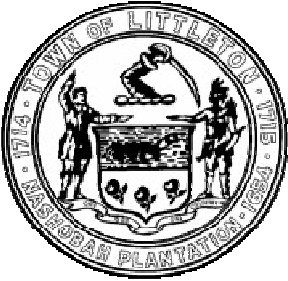

# Cost Estimate



- Track reconstruction \$640,463.10
  - Contingency \$64,046.31
  - Estimate Total \$704,509.41
  
- Alternate bid items (1 & 2 deferred by the School Committee—dependent on efficiencies gained within total budget)
  - 50-seat spectator seating \$7,500.00
  - Paved “D” areas \$68,153.68
  - Wind/sound berm \$62,842.60
    - School Committee is seeking donated time and materials

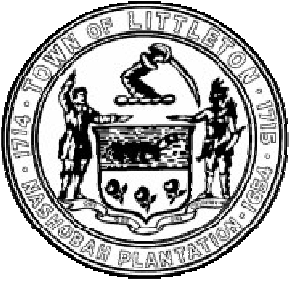

# Motion



- Moved and seconded by the Board of Selectmen that the Town vote to appropriate the sum of \$735,000 for the purpose of reconstructing the track facility located on Town-owned property at 55 Russell Street...
  - Amount requested includes Gale Associates good faith estimate, and soft costs of \$30,500 (owner's project management, administrative requirements...)



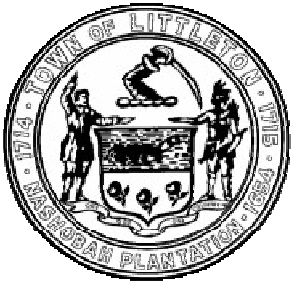

## Supported by:



- Board of Selectmen
- Finance Committee
- School Committee

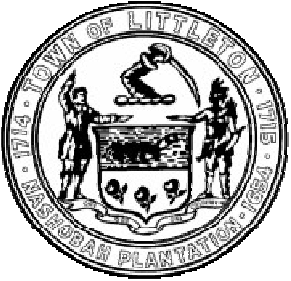

# Next Steps



- Tonight's Vote (2/3s)
- Town Election (simple majority)
  - Saturday, Nov 19, 2011, 8 a.m. to 8 p.m., LMS
- Permanent Municipal Building Committee
  - Prepare bid docs, put out to bid
  - Select construction firm
- Construction period of 120 days (est.)
- Usable track by Sep 30, 2012

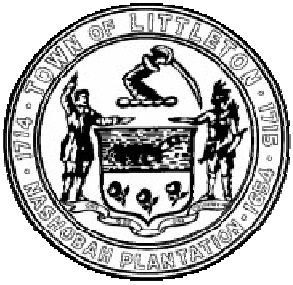

**Questions?**